

## Quick Nuts

MKA-8 Product # 1865100

Mount motors and accessories where there is limited space or when there's no access from below (as required by standard nuts and bolts).

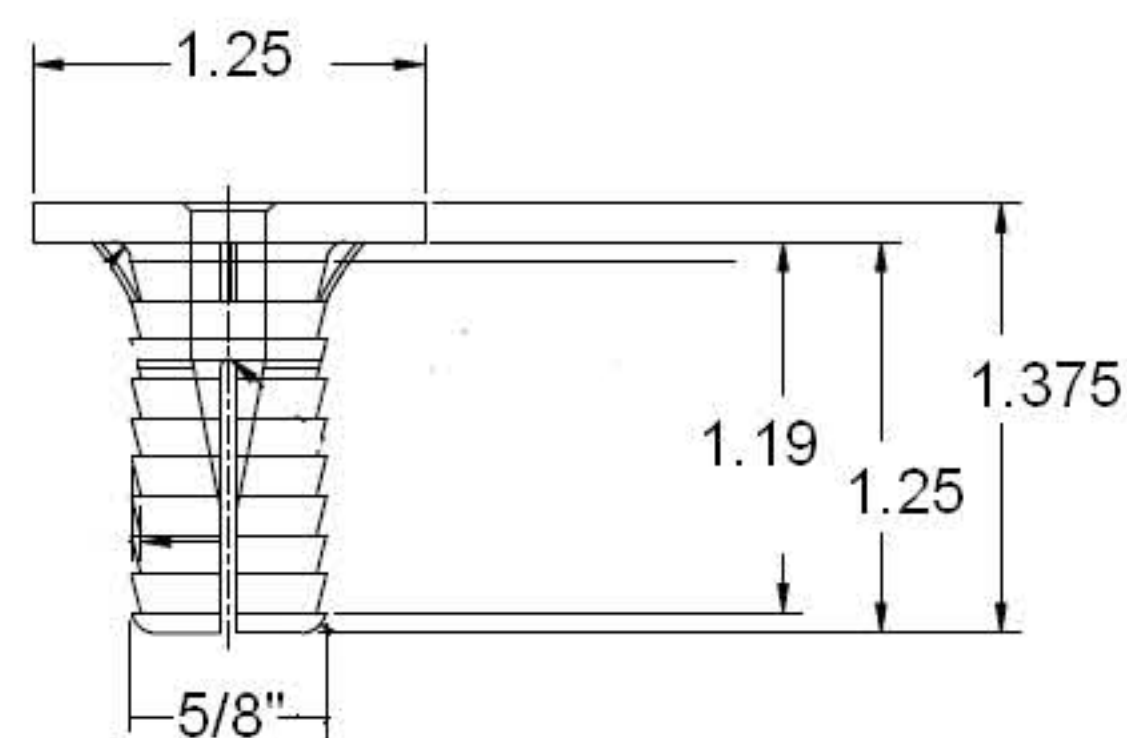

### INSTALLATION OF QUICK NUTS

1. Determine a suitable, level mounting surface on your boat.
2. Using the motor mount base as a template, mark and drill four 5/8" holes.
3. Insert the QUICK NUTS into the holes.
4. Align motor mount on top of QUICK NUTS.
5. Place the flat washers in the mounting counterbores of scissors mount or on the flat surface of the Power Drive.
6. Turn the supplied, self-threading phillips head screws into the QUICK NUTS. Make sure to apply sufficient downward force to prevent the QUICK NUTS from rotating in the hole.