

MINN KOTA

35

Model 35C

OPERATING INSTRUCTIONS

CAUTION: Never operate the motor out of water!

HANDLING AND CARRYING

Never pick up the motor by the steering grip as this might damage the speed control. A convenient carrying grip has been provided at the rear of the control head to facilitate handling, or the unit can be carried by its chrome-plated shaft.

POWER SUPPLY

Your Minn Kota electric fishing motor will operate with any 12 volt battery. For best results, a battery with at least an 80-ampere-hour rating is strongly recommended. Maintain the battery at full charge. This can be done with any standard battery charger.

MOUNTING ON THE BOAT

Your motor can be mounted on the transom, bow or either side of the boat. Tighten the clamp screws securely.

ADJUSTING DEPTH

Loosen steering tension knob (A) and set knob (B) until the shaft slides freely. Raise or lower the motor to the desired depth, and retighten set knob (B). The steering tension knob (A) may be left loose, or tightened as desired.

ADJUSTING TILT

The 10-position mounting bracket allows you to set your motor in a vertical position, angle it for fishing in shallow water, or tilt it completely out of the water when not in use. Simply depress and hold the tilt lock button (C), tilt the motor to the new position and release the button.

CONNECTING TO BATTERY

Make sure the speed control is off. Connect the red clamp to the positive (+) battery terminal, and the black clamp to the negative (-) battery terminal.

FORWARD/REVERSE SWITCH

A rocker switch has been provided on the control head for reversing direction. The unit is designed to prevent damage if direction is reversed while the motor is running.

SPEED CONTROL

The speed control on your new Minn Kota is located in the steering grip, and operates just like the throttle on an outboard motor. The 3-speed positions are conveniently indicated at the rear of the grip.

STEERING TENSION

The steering tension knob (A) should be adjusted to provide enough tension so that the motor turns freely, yet remains in any position without being held. It can also be used to lock the motor in a preset condition, to leave your hands free for fishing while trolling, etc.

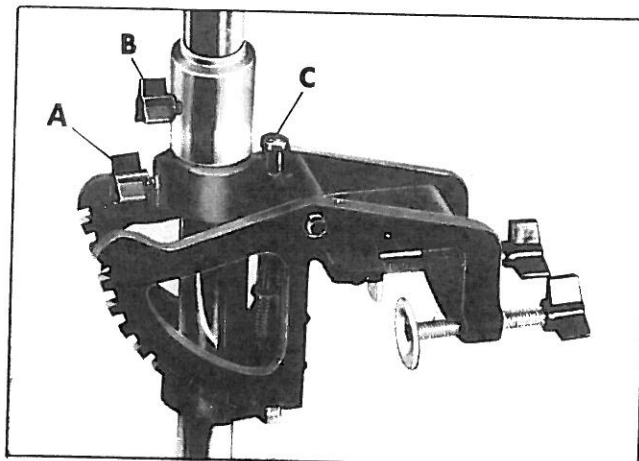

SERVICE

Your new Minn Kota Motor was built to exacting specifications, under rigid quality control, to provide you years of trouble-free operation. If, for some reason, it should ever need adjustment or service, your motor may

be sent to — Service Department, Minn Kota, Johnson Fishing Inc., 1531 Madison Ave., Mankato, Minn. 56001, or to any Minn Kota authorized service center.

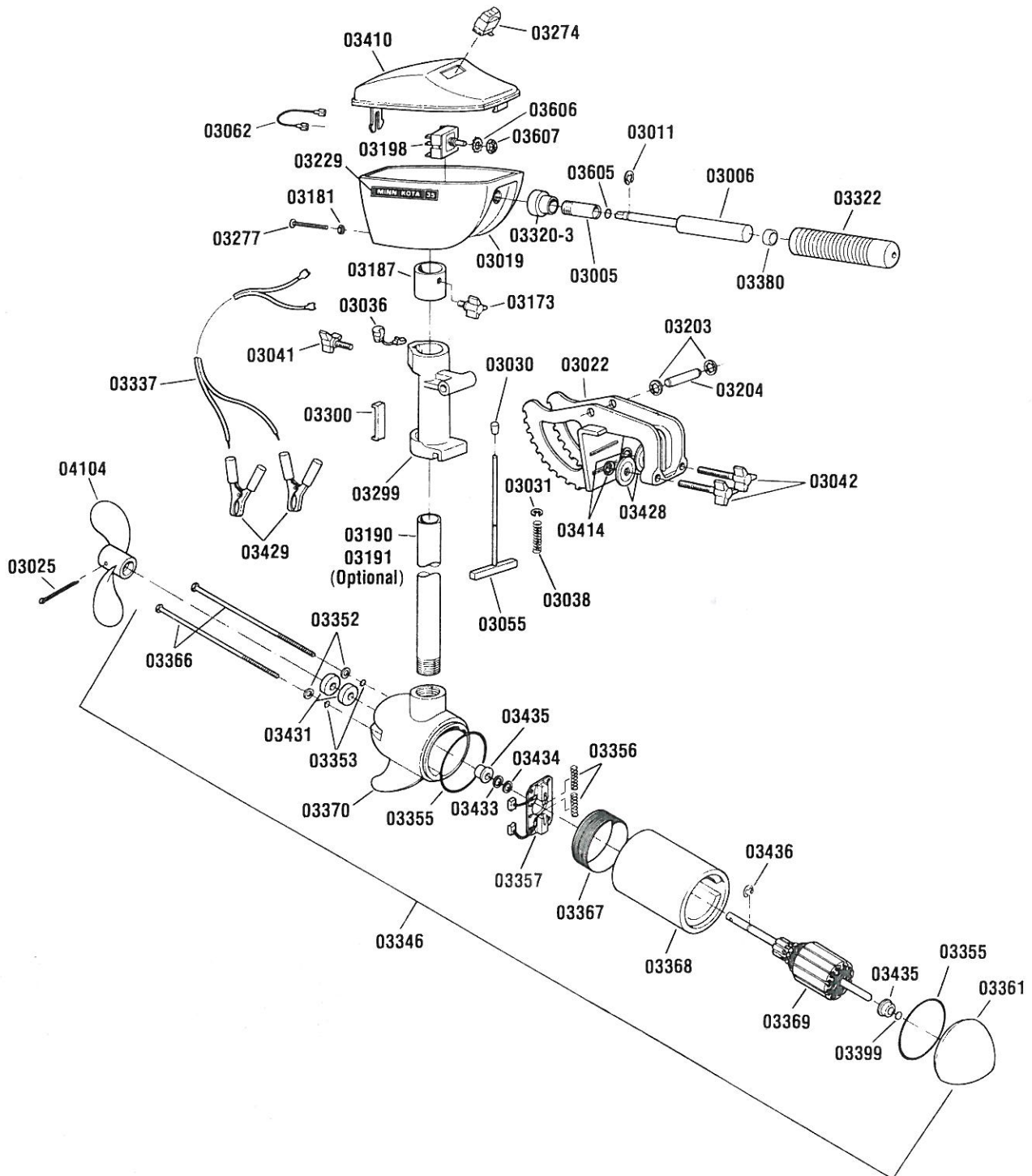

REPLACEMENT PARTS

Replacement parts may be ordered from Parts Dept. Minn Kota, Johnson Fishing Inc., 1531 Madison Ave., Mankato, Minn. 56001. Be sure to specify the model number and serial number of your motor, and the part number and name as it appears in the parts list. Minimum charge \$2.00.

Part No.	Description	Part No.	Description
03005	Handle Bearing	03337	Lead Wire Assembly including
03006	Handle		Battery Clips & Terminals
03011	E-Ring	03346	Motor Assembly
03019	Control Box	03352	Thru Bolt Washer
03022	Bracket	03353	Thru Bolt "O" Ring
03025	Cotter Pin	03355	"O" Ring (2 req.)
03030	Adjusting Knob	03356	Brush Spring
03031	E-Ring	03357	Brush Plate & Brush Assembly
03036	Strain Relief	03361	Front End Bell
03038	Spring	03366	Thru Bolts
03041	Hinge Tension Screw	03367	Speed Coil
03042	Clamp Screw (2 req.)	03368	Motor Shell with Magnets
03055	Adjusting Rod & Bar	03369	Armature
03062	Connecting Wire	03370	Rear End Bell with Seals & Bearings
03173	Collar Screw	03380	Handle Spacer
03181	Hex Nut	03399	Thrust Disc
03187	Set Collar	03410	Control Box Cover
03190	Tube 30"	03414	Retaining Ring
03191	Tube 36" (optional)	03428	Clamp Screw Washers
03198	Switch	03429	Battery Clips
03203	Speednut (2 req.)	03431	Seals
03204	Hinge Pin	03433	Thrust Washer
03229	Decal	03434	Steel Washer
03274	Switch	03435	Shoulder Bushing
03277	Screw	03436	E-Ring
03299	Hinge	03605	Handle "O" Ring
03300	Tension Block	03606	Switch Lockwasher
03320-3	Speed Indicator	03607	Switch Nut
03322	Handle Grip	04104	Propeller

TROUBLE-SHOOTING GUIDE

If the motor runs in reverse:

Reconnect the battery clamps to the opposite terminals.

If the motor fails to run, or has little power:

- 1) Check the battery clamps to insure a good tight connection. Battery terminals should be clean and free from corrosion. (A fine grade of sandpaper or emery cloth can be used to clean the terminals.)
- 2) Check the battery to insure that the water is at the proper level, and that it has a full charge.
- 3) If the battery has a full charge and the connections are

good, but the motor still fails to operate, obtain service as instructed.

If the motor runs normally, but loses power after a short period of time:

The fault is probably with the battery. Have it checked.

If the motor is hard to steer:

Loosen the steering tension set screw at the rear of the bracket. For all other malfunctions, obtain service as instructed.

WIRING DIAGRAM

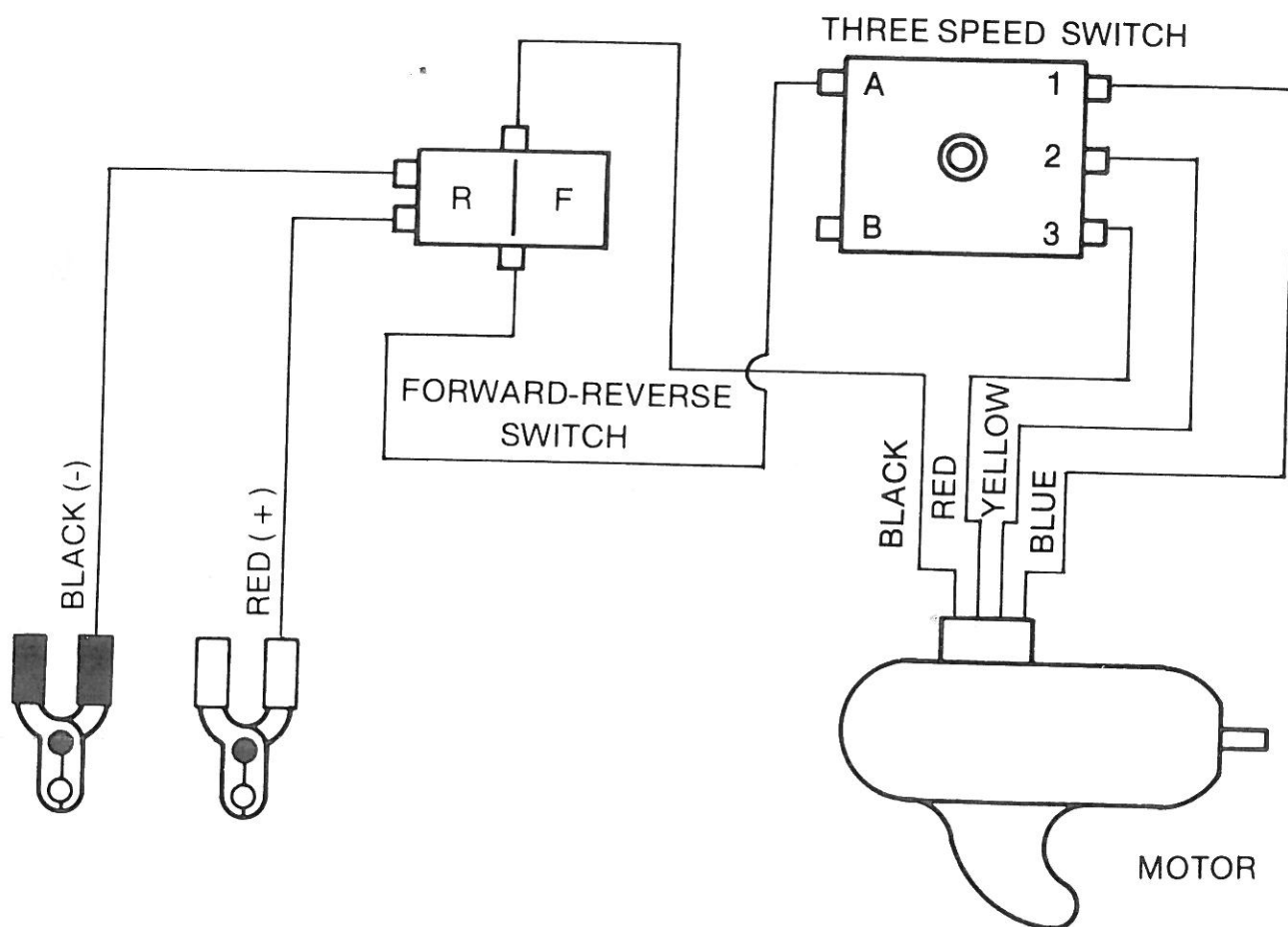

MINN KOTA

JOHNSON FISHING INC.
1531 MADISON AVENUE
MANKATO, MINNESOTA 56001
PHONE 507-345-4623

A  Johnson wax Associate