

Parts Diagram

35W

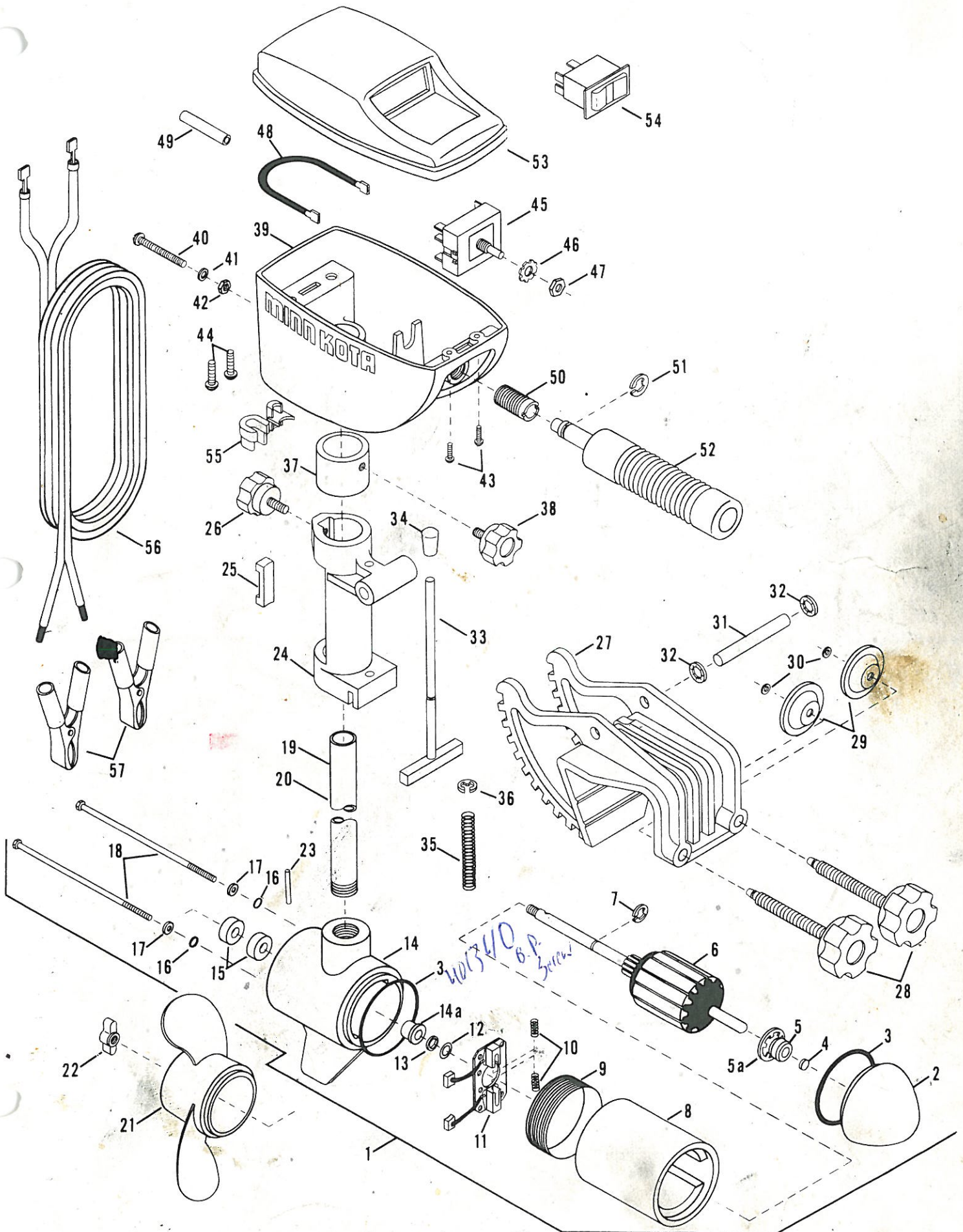

Replacement parts.

Replacement parts may be ordered from Parts Department, Minn Kota, Johnson Fishing, Inc., 1531 Madison Ave., Mankato, Minnesota 56001, or in Canada, from Parts Department, Minn Kota, Johnson Fishing, Inc., Box 82, Orillia, Ontario, Canada. Be sure to specify the model number and serial number of your motor and the part number(s) as shown on the following list. Minimum charge \$2.00. Payment may be by cash, check, MasterCard or VISA card. Please add \$2.00 for postage and handling on all orders.

Item No.	Part No.	Description
1	203106	Motor
2	401020	Front End Bell w/401600 Bearing
3	401460	O-Ring (2 req'd.)
4	401050	Thrust Disc
5	401600	Bearing
5A	405301	Bearing Retainer
6	403204	Armature
7	401300	E-Ring
8	403251	Center Section w/ Magnets
9	403241	Speed Coil
10	401080	Brush Spring (2 req'd.)
11	401401	Brush Plate Assembly
12	401170	Steel Washer
13	401171	Thrust Washer
14	403031	Rear End Bell
14A	401000	Shoulder Bushing
15	401461	Seal (2 req'd.)
16	401462	Thru Bolt O-Ring (2 req'd.)
17	401172	Thru Bolt Washer (2 req'd.)
18	403351	Thru bolt (2 req'd.)
19	203200	Tube (30")
20	203201	Tube (36" optional)
21	203115	Propeller
22	203311	Propeller Nut
22A	204172	Propeller Washer
23	208260	Shear Pin
24	203180	Hinge

Item No.	Part No.	Description
25	203280	Tension Block
26	203131	Tension Screw
27	203190	Bracket
28	201135	Clamp Screw (2 req'd.)
	203551	Decal (2 req'd.)
29	201171	Clamp Screw Washer (2 req'd.)
30	201301	Retaining Ring (2 req'd.)
31	201050	Hinge Pin
32	201310	Speed Nut (2 req'd.)
33	203360	T-Bar
34	201040	Tilt Knob
35	201270	T-Bar Spring
36	201300	E-Ring
37	203150	Collar
38	201134	Collar Screw
39	203251	Control Box
40	203340	Control Box Screw
41	203170	Lockwasher
42	203310	Hex Nut
43	207210	Cover Screw—Front (2 req'd.)
44	207212	Cover Screw—Rear (2 req'd.)
45	206400	4-Speed Switch
46	202170	Switch Lockwasher
47	202310	Switch Nut
48	202030	Connecting Wire
49	201540	Wire Insulator (4 req'd.)
50	202001	Handle Bearing
51	202300	E-Ring
52	203093	Handle Assembly
	203550	Decal
53	203021	Control Box Cover
	203562	Decal
	223661	Decal (2 req'd.)
54	203401	Fwd /Rev. Switch
55	201290	Strain Relief
56	202060	Lead Wire (includes Battery Clips and Terminals)
57	201070	Battery Clips (2 req'd.)

Wiring Diagram

Model 35W

