

Item	Part #	Description	Qty.
1	2372008	SPIKE .75"X56.4",8/12' **12' 3 STG, 8' 2 STG	1
	2372009	SPIKE .75" X 44.4", 6' ** 6' 2 STG	1
	2372007	SPIKE .75"X 48.4", 10' ** 10' 3 STG	1
	2372027	SPIKE 8' TALON 2 ** 8' 3 STG	1
	2372028	SPIKE, .75" X 68.4" T3 ** 15' 3 STG	1
2	2383464	SCREW-M4-.70 SET SS ** FOR 2 STG/PRE-BT 3 STG	1
3	2383477	SCREW-#8-16 X .875 PLASTITE ST ** FOR BT	1
4	2378601	RIVET-POP, 1/8", 316 SS ** USE OPTIONAL ON BT	2
5	2374632	O-RING 3/4" ID X 1/8"	1
6	2778825	SPIKE ISOLATOR WIPER ASM, SERV.	1
7	2372654	PIN-SPRING 1/8"X 1 1/4" SS	1

Items 3 & 4 not included in kit 2882009 (for 6' 2 Stage Talons)
 Item 2 not included in kit 2882028 (for 15' BT Talon)

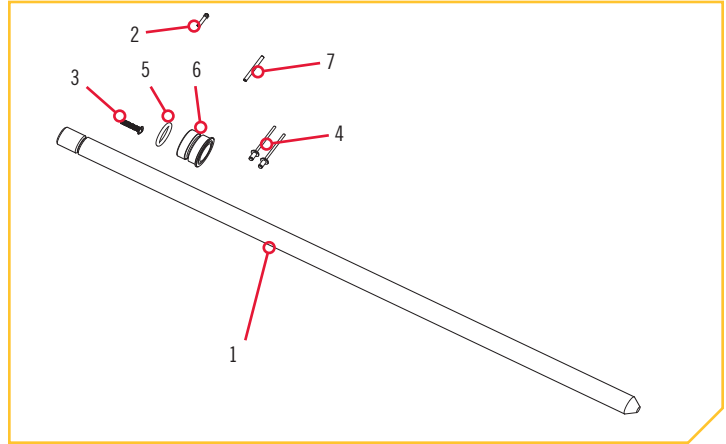

TOOLS AND RESOURCES REQUIRED >

- 1/8" Punch
- Hammer
- 3/32" Hex Key/Allen Wrench
- 5/64" Hex Key/Allen Wrench
- 10-15 Minutes

CAUTION

Always wear safety glasses and gloves. Disconnect all power to the Talon before beginning any work or maintenance. Johnson Outdoors Inc. is not responsible for any damage due to improper rigging or installation. If you do not have the skills, experience and tools to perform the following maintenance and repairs we recommend you seek the help of a Minn Kota Authorized Service Providers.

A list of Authorized Service Providers can be found at <https://www.minnkotamotors.com/Authorized-Service-Providers/>. Or contact our Technical Service Department by email at service@minnkotamotors.com or by dialing 800-227-6433

CONSIDERATIONS >

2017 and Later Talons (BT Models) have a different spike retention method than prior Talon Models. The first set of instructions (Pages 2-4) will be for installation on BT Models, for earlier models refer to the second set of instructions (Pages 5-6).

If you are unsure which model Talon you are working on the remote is the easiest indicator. Talons that include black remotes with four buttons are BT Models, if the included remotes were white with two buttons the Talon is an earlier model.

BT Remote





Earlier Remote



INSTALLATION

1

- Press the Down  button on the Indicator Panel or Double Click the Down  button on the Remote to extend the Spike out so that the Second Stage begins to exit the bottom of the Talon. This may require removing the Talon from the Mounting Bracket, and laying it horizontally or on a flat surface.
- Once extended, remove the Talon from the Power Source.

CAUTION

Before beginning any maintenance work, disconnect the Talon from the battery or if connected to a battery selector switch or power disconnect switch, make sure that it is turned to the "off" position. Failure to disconnect power during maintenance work may result in shock, unexpected operation and/or injury.

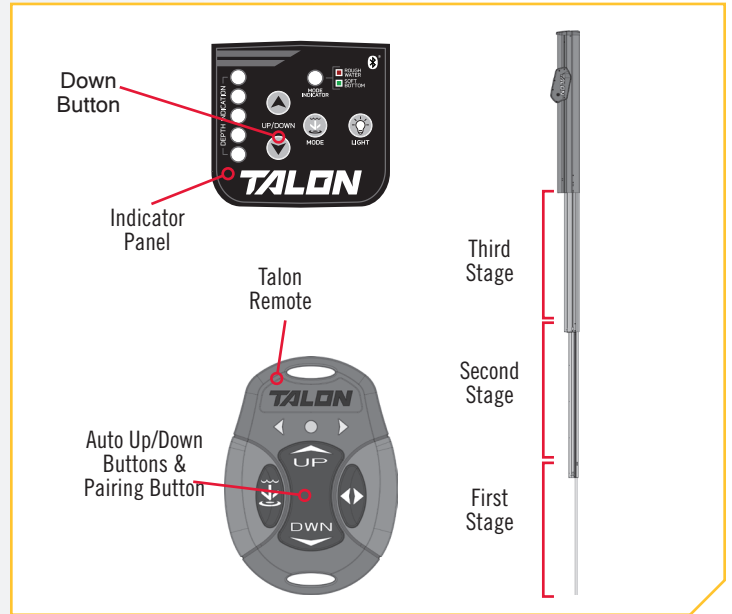

2

- Locate the Spike Isolator Retainer Pin in the Second Stage of the Talon. Carefully remove the Retainer Pin using a 1/8" Pin Punch and Hammer.
- Set the Spike Isolator Retainer Pin aside for later use, in reassembly. Slide the Spike Isolator along the Spike, away from the Second Stage.
- Gently pivot the Second Stage Debris Shield up out of the way to access the Spike Retainer Screw. The adjacent plastic Debris Channel Tab will bend slightly, but can be tapped back into place with a small hammer after the Spike is replaced.

NOTICE: It is normal to experience cosmetic changes in the appearance of the Debris Channel Tab during this procedure. You may use a Drill with a 1/8" Drill Bit to remove the rivets retaining the Debris Shield and then remove the Debris Shield without affecting the Debris Channel. Two Rivets are included for this option.

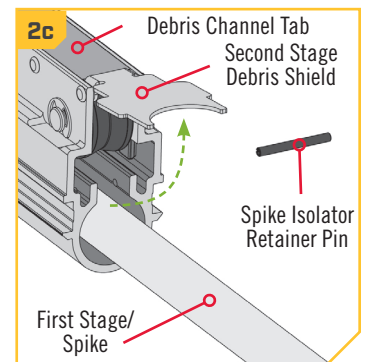
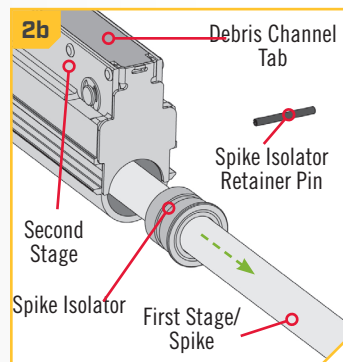
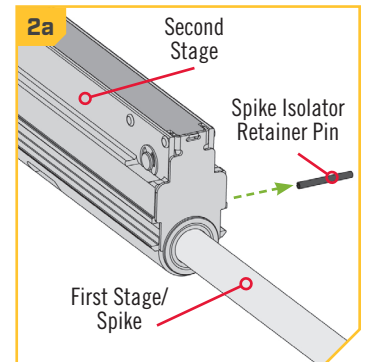
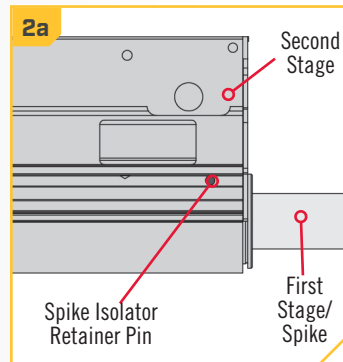

3

- a. Locate the Spike Retainer Screw and remove it using a 3/32" Allen Wrench.
- b. Once removed, the Spike should pull free from the Second Stage along with the Spike Retainer and an O-ring that is in place around the Spike. The Spike Retainer is the piece that the Spike Retainer Screw was just removed from.
- c. Discard the Spike Retainer Screw, Spike, O-ring and Spike Isolator that were just removed. Keep the Spike Retainer for reassembly.

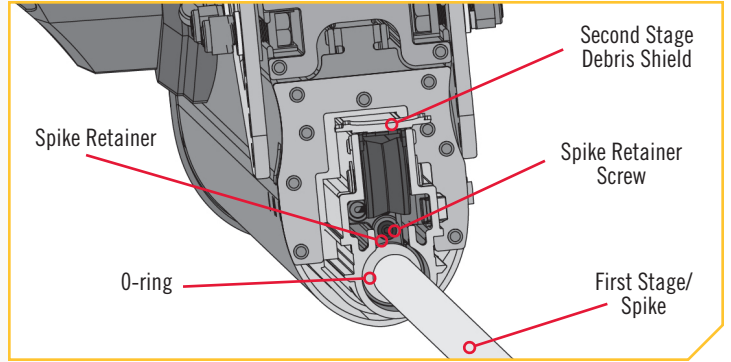

4

- a. Take the new Spike and locate the groove along one end. Slide the new Spike Isolator and then O-ring onto the Spike on the end where the groove is located. Slide them down so they are 5 to 6 inches past the end of the Spike.
- b. Locate the raised ring on the inside curve of the Spike Retainer and align it with the groove at the end of the Spike. Place the Spike Retainer on the Spike so that it is keyed in place by aligning the raised ring and groove.

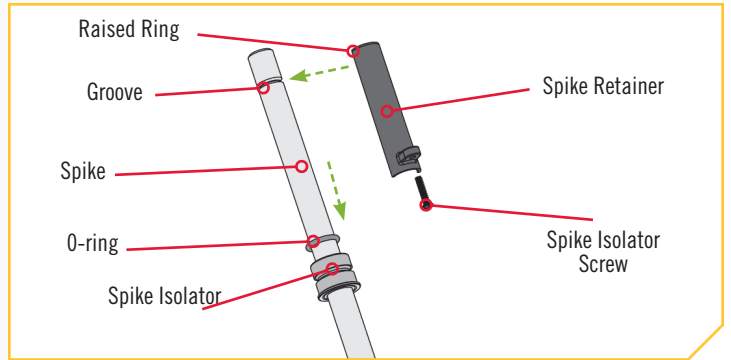

5

- a. Slide the assembly back into the Second Stage and replace the Spike Retainer Screw in the Spike Retainer using a 3/32" Allen Wrench.
- b. Once the Screw is secure, close the Second Stage Debris Shield.
- c. Push the O-ring and Spike Isolator towards the Second Stage and until they are in position against the Spike Retainer and Second Stage Debris Shield.

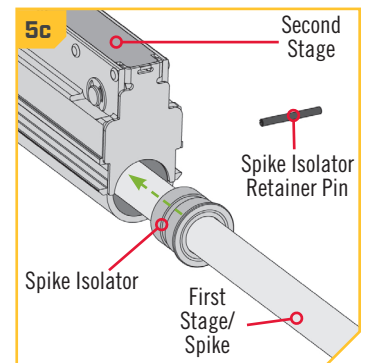
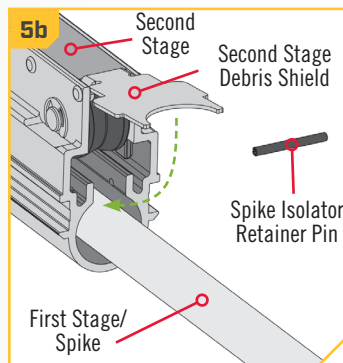
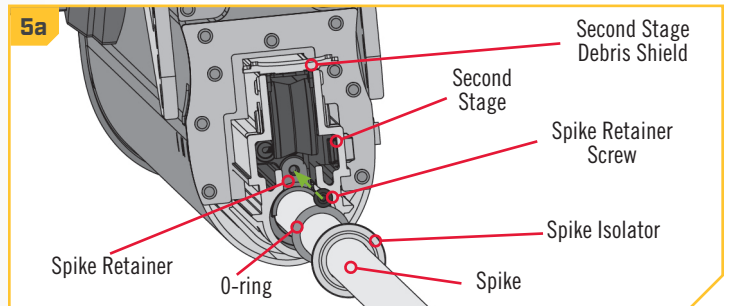

6

- a. Carefully replace the Spike Isolator Retainer Pin, making sure the ends of the pin are recessed on both sides.
- b. If the Talon was removed to replace the Spike, reassemble the Talon into the Mounting Bracket. Reconnect power before using the Talon or retracting the Spike.
- c. Press the Up ▲ button on the Indicator Panel or the Up UP button on the Remote to retract the Talon.

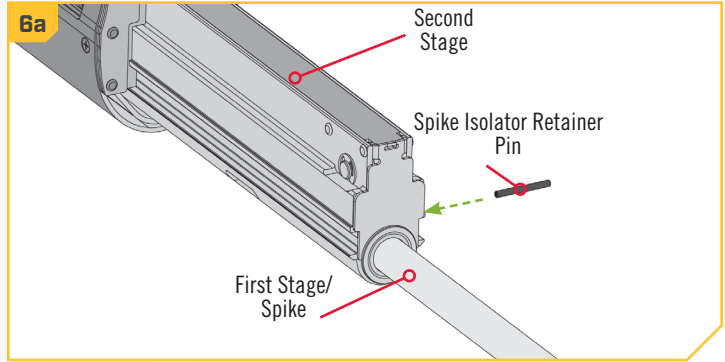

TALON SPIKE REPLACEMENT: EARLIER/NON-BT MODELS

TOOLS REQUIRED: 1/8" Ø PUNCH, 5/64" or 2 mm ALLEN HEX KEY, SMALL HAMMER, PHILLIPS SCREWDRIVER

1. Remove the Talon from the main mounting bracket by loosening the (4) four 5/16" bolts located on each side of the Talon. Remove the Talon and lay it down horizontally on a flat surface or the deck of the boat.

DO NOT DISCONNECT FROM POWER.

2. Power the unit down, with either the remote or control panel switches, until the 2nd stage begins to exit the bottom of the anchor. To stop the unit, press the "UP" button once at the desired location.

See Photo 1.

3. Disconnect power from the unit by either removing the 30 amp in-line fuse or removing the ring terminal from the positive (+) battery post.

4. Using a 1/8" Ø punch and small hammer, drive out the spike isolator retaining pin to remove the spike isolator. Slide the isolator out of the 2nd stage over the spike. **See Photo 2.**

5. If your Talon has the older 2372657 spring pin you will need to remove it through the slotted window opening using the same 1/8" Ø punch. If your Talon has the current 2383464 set screw, a 5/64" or 2mm Allen hex key will need to be used for removal. Once removed, the spike can be removed from the anchor. The retaining pins and rubber o-ring do not need to be retained as new components are included with the replacement spike. **See Photo 3.**

Note: The set screw is a direct replacement for the spring pin.

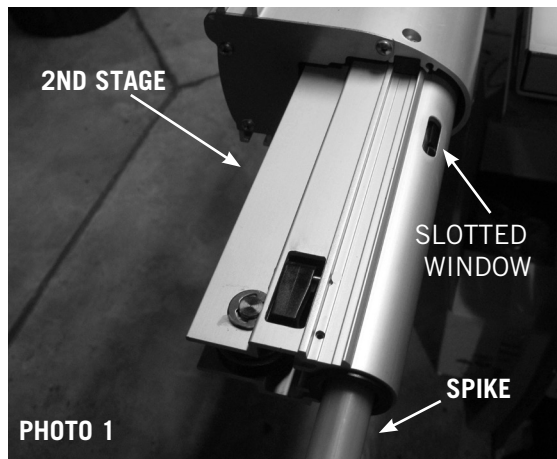

- Slide the new spike into the anchor, aligning the groove with the pin hole. If the obsolete 2372657 spring pin was previously used, replace it with the current 2383464 set screw. Use a 5/64" or 2mm Allen hex key to turn the set screw into the spike isolator until it is flush on both sides. Once in place, slide the o-ring up the spike as far as it can go.

See Photos 4 & 5.

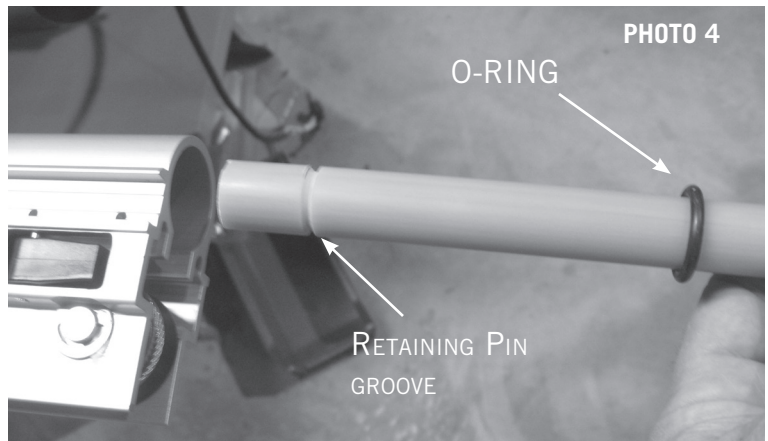

- Re-install the spike isolator by sliding up the spike until the groove is aligned with the pin hole. Carefully replace the retaining pin, making sure the ends of the pin are recessed on both sides.

See photo 6.

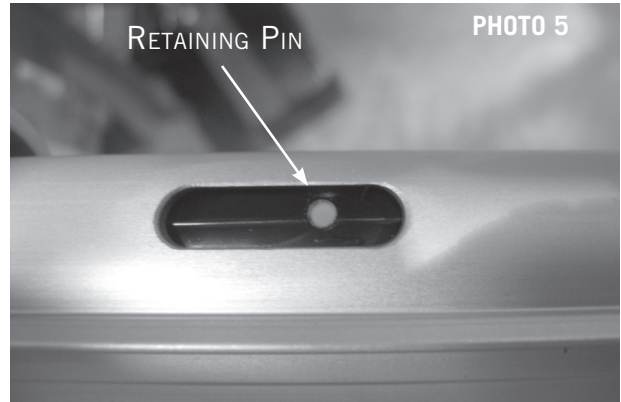

- Reconnect the power and retract the unit by pressing the "UP" button until the Talon is fully retracted.

- Re-install the Talon in the mounting bracket.

Note: Below are descriptions of the two possible types of spike retention pins that your Talon may have.

SET SCREW - 2383464

SPRING PIN - 2372657

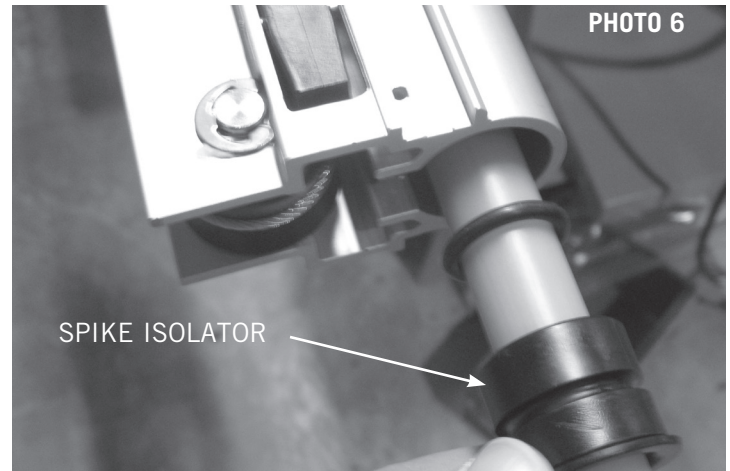

Minn Kota Consumer & Technical Service
Johnson Outdoors Marine Electronics, Inc.
PO Box 8129
Mankato, MN 56001

121 Power Drive
Mankato, MN 56001
Phone (800) 227-6433
Fax (800) 527-4464



©2017 Johnson Outdoors Marine Electronics, Inc.
All rights reserved.